

One perfect cup at a time, anytime.



Visit commercial.Keurig.com for troubleshooting videos, maintenance recommendations, and the full Use & Care Guide.

Have questions? We're here to help.

Still need help? Give us a call at 1-866-669-8922.

DC00000018765 REV A

Authentic, full-flavored coffeehouse taste.

Warranty

Keurig Green Mountain, Inc., warrants to the original purchaser that its brewer will be free of defects in materials or workmanship under normal use for one year from the date of purchase. Keurig, a Keurig Authorized Distributor, or Service Agent will, at their option, repair or replace a defective brewer under this warranty without charge upon receipt of proof of the date of purchase. If a replacement brewer is necessary to service this warranty, the replacement brewer may be new or reconditioned. If a replacement brewer is sent, a new limited one-year warranty will be applied to the replacement brewer. This warranty only applies to brewers operated in the United States. This warranty gives the original purchaser specific legal rights, and you may also have other rights that vary from state to state and, in the case of Canada, from province to province. If you obtained this brewer through sale or rental from a Keurig Authorized Distributor, you may also want to refer to your Distributor's warranty policies. Only the use of Keurig® K-Cup® brand pods and accessories will guarantee the proper functioning and lifetime of your Keurig® brewer. Any damage to or malfunction of your brewer resulting from the use of non-Keurig® K-Cup® brand pods and accessories may not be covered by this warranty or may result in a service fee if the damage or malfunction is determined to be caused by such use.

What is not covered by the Limited Warranty?

THIS WARRANTY DOES NOT COVER CONSEQUENTIAL OR INCIDENTAL DAMAGES SUCH AS PROPERTY DAMAGE AND DOES NOT COVER INCIDENTAL COSTS AND EXPENSES RESULTING FROM ANY BREACH OF THIS WARRANTY, EVEN IF FORESEEABLE. Some states or provinces do not allow the exclusion or limitation of incidental or consequential damages, so the above limitation or exclusion may not apply to you depending on the state or province of purchase. Nor does this warranty cover damages caused by use of non-Keurig® K-Cup® brand pods or accessories, services performed by anyone other than Keurig or its authorized service providers, use of parts other than genuine Keurig® parts, or external causes such as abuse, misuse, inappropriate power supply, or acts of God.

Other Limitations

THIS WARRANTY IS EXCLUSIVE AND IS IN LIEU OF ANY OTHER EXPRESS WARRANTY, WHETHER WRITTEN OR ORAL. IN ADDITION, KEURIG HEREBY SPECIFICALLY DISCLAIMS ALL OTHER WARRANTIES WITH RESPECT TO YOUR K-2550™ BREWER, INCLUDING ANY IMPLIED WARRANTY OF MERCHANTABILITY OR FITNESS FOR ANY PARTICULAR PURPOSE. Some states or provinces do not allow disclaimers of such implied warranties or limitations on how long an implied warranty lasts, so the above limitation may not apply to you depending on the state or the province of purchase.

How do you obtain warranty service?

Keurig® brewers are high-quality appliances and, with proper care, are intended to provide years of satisfying performance. However, should the need arise for warranty servicing, simply call your Keurig Authorized Distributor (KAD) who originally sold you the brewer or your Keurig Authorized Service Provider (KASP) for full support. To be reconnected with your KAD or KASP, please call Keurig at 1-866-669-8922. Keurig Green Mountain, Inc., Burlington, MA 01803 U.S.A.

Open Source Compliance

For information on the open source compliance for this brewer, please visit <https://commercial.Keurig.com/compliance>.



When using electrical appliances, basic safety precautions should be followed, including the following:

IMPORTANT SAFEGUARDS

Distributor to report any malfunction of or damage to the brewer.

10. The use of accessory attachments not authorized by the appliance manufacturer may result in fire, electric shock, or injury to persons.

11. Do not use outdoors.

12. Do not let cord hang over edge of table or counter or touch hot surfaces.

13. Do not place on or near a hot gas or electric burner or in a heated oven.

14. Always attach plug to appliance first (if not permanently attached), then plug cord into the wall outlet. To disconnect, turn any control to "off" (if applicable), then remove plug from wall outlet.

15. Do not use appliance for anything other than intended use.

16. Use brewer in upright position only.

17. The appliance must be grounded using a properly grounded 3-hole outlet.

18. Only use pods intended for this appliance. If the pod does not fit, do not force the pod into the appliance.

1. **READ ALL INSTRUCTIONS.**
2. For household and commercial use only.
3. Do not fill water reservoir above **MAX FILL** line or use distilled water.
4. Scalding may occur if the handle is opened during the brewing process.
5. Do not touch hot surfaces. Use handles or knobs.
6. To protect against fire, electric shock, and injury to persons, do not immerse appliance, cord, or plugs in water or other liquid.
7. Close supervision is necessary when any appliance is used by or near children.
8. Unplug from outlet when not in use and before cleaning. Allow to cool (90 minutes) before putting on or taking off parts and before cleaning the appliance.
9. Do not operate any appliance with a damaged cord or plug or after the appliance malfunctions or has been damaged in any manner. Contact a Keurig Authorized

SAVE THESE INSTRUCTIONS.

CAUTION: HOT COCOA/OTHER NON-COFFEE PODS: Immediately after using a hot cocoa/other pod, run a hot water brew cycle without a pod to avoid the possibility of clogging the exit needle. DO NOT assume the next user will do this.

- i. The marked electrical rating of the detachable power-supply cord or extension cord should be at least as great as the electrical rating of the appliance.
- ii. If the appliance is of the grounded type, the extension cord should be a grounding type 3-wire cord.
- iii. The longer cord should be arranged so that it will not drape over the countertop or tabletop, where it can be pulled on by children or tripped over.

7. **CAUTION: HOT COCOA/OTHER NON-COFFEE PODS:** Immediately after using a hot cocoa/other pod, run a hot water brew cycle without a pod to avoid the possibility of clogging the exit needle. DO NOT assume the next user will do this.

**WARNING**
RISK OF FIRE OR ELECTRIC SHOCK DO NOT OPEN



WARNING, TO REDUCE THE RISK OF FIRE OR ELECTRIC SHOCK, DO NOT REMOVE COVER (OR BACK) NO USER SERVICEABLE PARTS INSIDE

- a. A short power-supply cord is provided to reduce risks resulting from becoming entangled in or tripping over a longer cord.
- b. Longer detachable power-supply cords or extension cords are available and may be used if care is exercised in their use.
- c. If a long detachable power-supply cord or extension cord is used:

6. **POWER CORD INSTRUCTIONS:**

5. **CAUTION:** There are two sharp needles that puncture the pod, one above the K-Cup® pod holder and the other in the bottom of the K-Cup® pod holder. To avoid risk of injury, be aware of the needle locations.

4. **CAUTION:** Keurig recommends using only Keurig® K-Cup® pods in this appliance. Non-Keurig® brand pods may cause brewer malfunction or injury.
3. **WARNING:** Used K-Cup® pods should be removed from the pod holder, and the drip tray and water reservoir (if applicable) should be rinsed clean regularly or as part of the daily cleaning routine.

1. **WARNING:** Keep all plastic bags away from children.
2. **WARNING:** There is extremely hot water under pressure in the K-Cup® pod holder during the brew process. To avoid risk of injury, do not lift the handle or otherwise open the handle during the brew process.
3. **WARNING:** Used K-Cup® pods should be removed from the pod holder, and the drip tray and water reservoir (if applicable) should be rinsed clean regularly or as part of the daily cleaning routine.

PLUMBING INSTRUCTIONS

If you have purchased the K-2550™ Water Reservoir Kit:

CAUTION: This brewer is designed to handle local water pressures from 40 psig up to 125 psig. Consult a licensed plumber for water pressures in your area. Use plumbing fittings and tubing specified to withstand 125 psig.

- Remove all pieces of packing tape from the brewer and drip tray. Remove the clear plastic film from the touch screen.
NOTE: An external filter (KQ8A, #5572) can be mounted on the rear surface of the brewer using the mounting screws provided.
- Attach a threaded straight adapter to both the IN and OUT ports on the Omnipure KQ8A Water Filter and tighten using an 1/4" (18 mm) wrench. Make sure the connections are secure, but do not overtighten.

- Attach the filter mounting bracket to the Omnipure KQ8A Water Filter using the four screws provided.
NOTE: The top of the Omnipure KQ8A Water Filter has two ports labeled IN port and OUT port. Make sure these ports are aligned with the filter mounting bracket.

- Loosen the two mounting screws located on the upper rear of the brewer and hang the filter kit assembly. Tighten the screws but be careful not to overtighten.
NOTE: The filter kit assembly comes with 1/4" FPT ports for both inlet and outlet, and the plumbed water inlet to the brewer is 3/4" female garden hose thread (inverts solenoid valve). NSF-compliant, 1/4" OD LLDPE (linear low-density polyethylene) tubing is recommended between the filter kit assembly and the brewer. NSF-compliant fittings such as high-density polypropylene type are recommended.
- Connect a stem elbow fitting to the IN port of the filter kit assembly by pushing the stem elbow fitting into the previously attached adapter. Push firmly until the connection is secure. Secure LLDPE tubing to the stem elbow fitting in the same fashion and connect it to the local water supply.

Please reference the Quick Start Guide that was included with the kit for setup instructions to get you started.

If you are not using the K-2550™ Water Reservoir Kit, please follow the plumbing instructions below to install your water supply and filter.

WARNING: Keurig® requires the use of an external water filter such as the Omnipure KQ8A Water Filter, available from Keurig®. Failure to use a filter invalidates the brewer warranty.

- You may wish to install a shutoff valve between the water source and the Omnipure KQ8A Water Filter. To do this, cut some LLDPE tubing to the needed size and connect it by pushing the tubing into the shutoff valve until secure.

- Connect a long length of tubing to the OUT port of the filter kit assembly. Do not connect the brewer yet.
NOTE: The Omnipure KQ8A Water Filter needs an initial flush to clear any carbon deposit.

NOTE: The equipment shall be installed with adequate backflow protection to comply with applicable federal, state, and local codes.

- Turn on water supply and allow at least 4 gallons of water to flush through the filter. Turn off water supply.
- Cut the tubing to the length needed and connect a stem elbow fitting to the cut end of tubing. Thread the 3/4" female garden hose connector onto the brewer inlet valve located at the lower rear of the brewer. Push the stem elbow fitting into the connector until secured firmly. Then turn on the water supply.

NOTE: Water and waste piping and connections must comply with the latest code from the International Code Council (ICC) or International Association of Plumbing and Mechanical Officials (IAPMO).

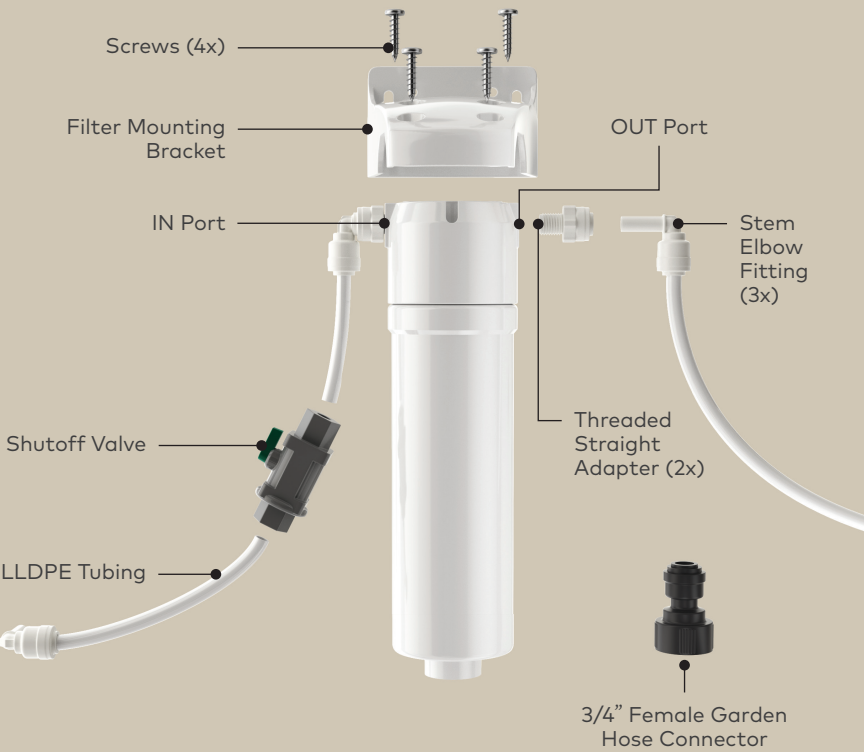

BEFORE YOU BREW

If you have purchased the K-2550™ Water Reservoir Kit:

Please reference the Quick Start Guide included with the kit to get started.



Power On

Locate the power switch on the back of the brewer and turn the brewer on. The brewer's touch screen will display "Please connect the brewer to a water source."

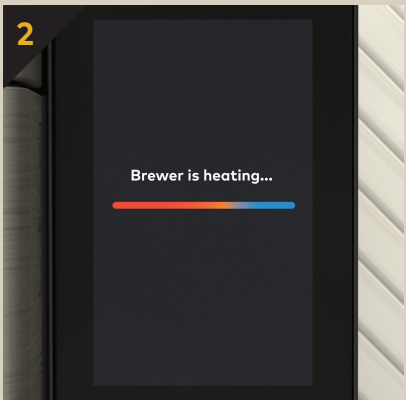

Heat Up

The brewer will automatically fill the hot water tank and begin heating. The heating process will take about 3 minutes. During this time, the brewer's touch screen will display "Brewer is heating."



Lift & Lower

Place a mug on the drip tray plate and then fully raise the handle. Lower the handle to close the lid over the K-Cup® pod holder.

NOTE: A K-Cup® pod should not be used for this sequence.

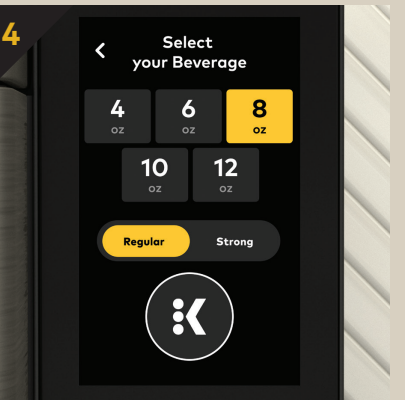

Cleansing Brew

When prompted to select your beverage, press **12oz** to start the cleansing brew. When the cleansing brew is complete, discard the hot water from the mug. The brewer will enter its idle state and be ready to brew your first K-Cup® pod.

CAUTION: While brewing, there is extremely hot water in the K-Cup® pod holder. To avoid injury, do not lift the handle during the brewing process.

BREW YOUR FIRST CUP



Place Mug & Pod

Place a mug on the drip tray plate. Lift the handle and place a K-Cup® pod in the K-Cup® pod holder.

Lower the handle completely to close the lid.

NOTE: Do not remove the foil lid on the K-Cup® pod.

BREW YOUR FIRST CUP

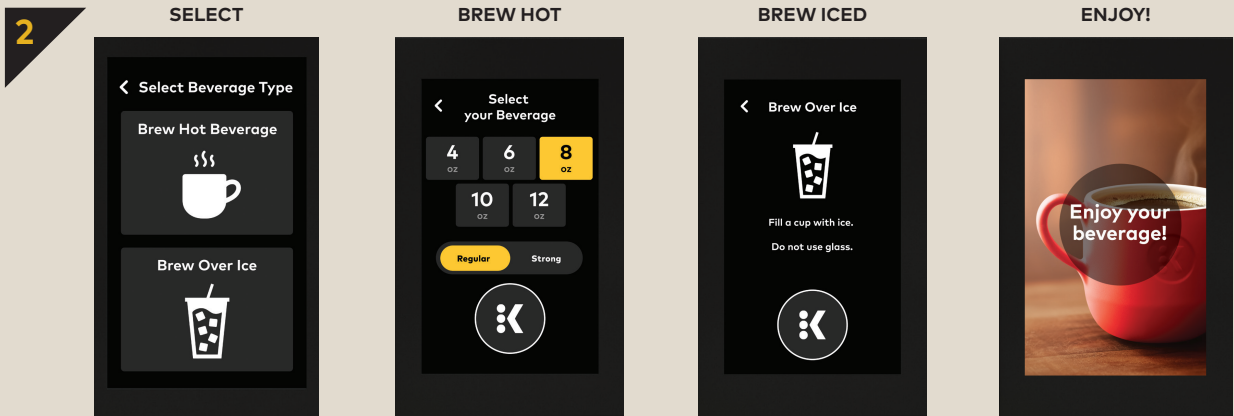

Brew & Enjoy!

Make a selection on the Select Beverage Type screen.

Brew Hot: Select Brew Hot Beverage. The display will show a choice of 4, 6, 8, 10, and 12oz brew sizes, as well as an option to brew on strong. Select your brew size by pressing the corresponding button on the touch screen. You may choose to press the **Strong** button either before or after selecting your brew size. When the desired selections are highlighted in yellow, press the flashing K icon. Brewing is complete when you see the display "Enjoy your beverage!"

Brew Iced: Do not brew hot over ice into a glass cup. Select Brew Over Ice. Press the flashing K icon to begin brewing. Brewing is complete when you see the display "Enjoy your beverage!"

BREWER FEATURES

Brewing Iced Beverages: Make sure you do not use a glass cup. Fill large cup with ice and place a K-Cup® pod in the K-Cup® pod holder. Follow Brew Iced instructions under the Brew Your First Cup section and enjoy!

Water Source Options: The K-2550™ brewer has the capability to have a plumbed or refillable water source. For more information on how to purchase or install the K-2550™ Water Reservoir Kit, please contact your Keurig Authorized Distributor.

Strong Brew: Increases the strength and bold taste of your coffee's flavor. For bolder coffee, press the **Strong** button so it is highlighted in yellow and select your brew size.

Commercial Rating: Ensures that the K-2550™ brewer will stand up to the demands of your coffee station. Enjoy the convenience of a touch screen, an industrial easy-grip handle, and a plumbed water tank for back-to-back brewing.

Intelligent Auto-On: With this feature enabled, the brewer will identify brew patterns from the previous four days. It will then automatically turn on the brewer 15 minutes before the anticipated brew time each morning.

High Altitude Brewing: When brewing in higher altitudes (over 5,000 feet), please enable the High Altitude Brewing mode on your brewer. To enable this mode, you will need to access the Technician Menu. See your Use & Care Guide for more details.

Travel Mug Friendly: Remove the drip tray to accommodate most travel mugs.

BREWER CARE

Regular cleaning keeps your brewer running smoothly. **Always be sure to turn off your brewer before cleaning.** For detailed brewer cleaning instructions, videos, and the full Use & Care Guide, visit commercial.keurig.com.

If the brewer has been in storage or hasn't been used for days, run a cleansing brew before brewing your beverage.

Periodically **hand-wash** the drip tray with warm, soapy water. Rinse clean.

CAUTION: Parts are not dishwasher safe.